



**GEOTECHNICAL LABORATORIES**  
 ACN 102 571 077  
 Factory 1/8-10 Catalina Drive, Tullamarine Vic 3043  
 PO Box 184 Keilor VIC 3036  
 PH: (03) 9335 1225 Fax: (03) 9335 1775

## DAILY SUMMARY - FIELD DENSITY TESTS

REPORT NO.: # 1916/041

LOCATION: DRAPERS - The Quay 2 Estate Stage 3

DATE OF TESTS	TEST NUM.	TEST LOCATION	FIELD WET DENSITY (t/m <sup>3</sup> )	FIELD MOISTURE CONTENT (%)	HILF DENSITY RATIO STANDARD (%)	STANDARD PCWD OR APCWD (t/m <sup>3</sup> )	STANDARD OPTIMUM MOISTURE CONTENT (%)	PROBE DEPTH SETTING (mm)	VARIATION FROM OPTIMUM MOISTURE CONTENT (%)	MOISTURE RATIO (%)	WET +19mm (%)	WET +37.5mm (%)	APPROX. DEPTH BELOW FINISH LEVEL (mm)	
18/01/17	1	<i>Refer to #1916/042 for approx. test site locations.</i>	2.14	15.0	99.0	2.15	15.5	175	0.0 Drier	98.5	0	0	600	
18/01/17	2		1.96	10.0	95.0	2.06	12.5	175	2.5 Drier	80.5	0	0	600	
18/01/17	3		2.04	16.0	100.5	2.03	16.5	175	0.5 Drier	97.0	0	0	400	
-	-		-	-	-	-	-	-	-	-	-	-	-	-
-	-		-	-	-	-	-	-	-	-	-	-	-	-
-	-		-	-	-	-	-	-	-	-	-	-	-	-

NOTES: Onsite Sandy Clay Fill

Test sites located - Geolab Procedure 4, Part 4.4.

Compaction specimens sampled after compaction.

Start Time: 11:40am Finish Time: 12:06pm

A Hilf Rapid Compaction test was carried out on a sample taken from each Field Density location to obtain the Compaction Parameters tabulated on this Report.

Soil Layer thickness: 200mm

Hilf Density Ratio and Hilf Moisture Variation ,Hilf Adjusted (APCWD) & Peak (PCWD) Converted Wet Density AS 1289 5.7.1

Field Density, Nuclear Gauge: AS 1289 5.8.1

Materials Sampled : AS 1289 1.2.1 Clause 6.4(b)

❖

❖



Moisture Content: AS 1289 2.1.1

Compaction Test: AS 1289 5.7.1

Accredited for compliance with ISO/IEC 17025. The results of the tests, calibrations and/or measurements included in this document are traceable to Australian/National standards. This document may not be reproduced except in full.

NATA Accredited Laboratory Number 14561

SAM LOZA

(Approved Signatory)

Issue Date: 13/2/2017

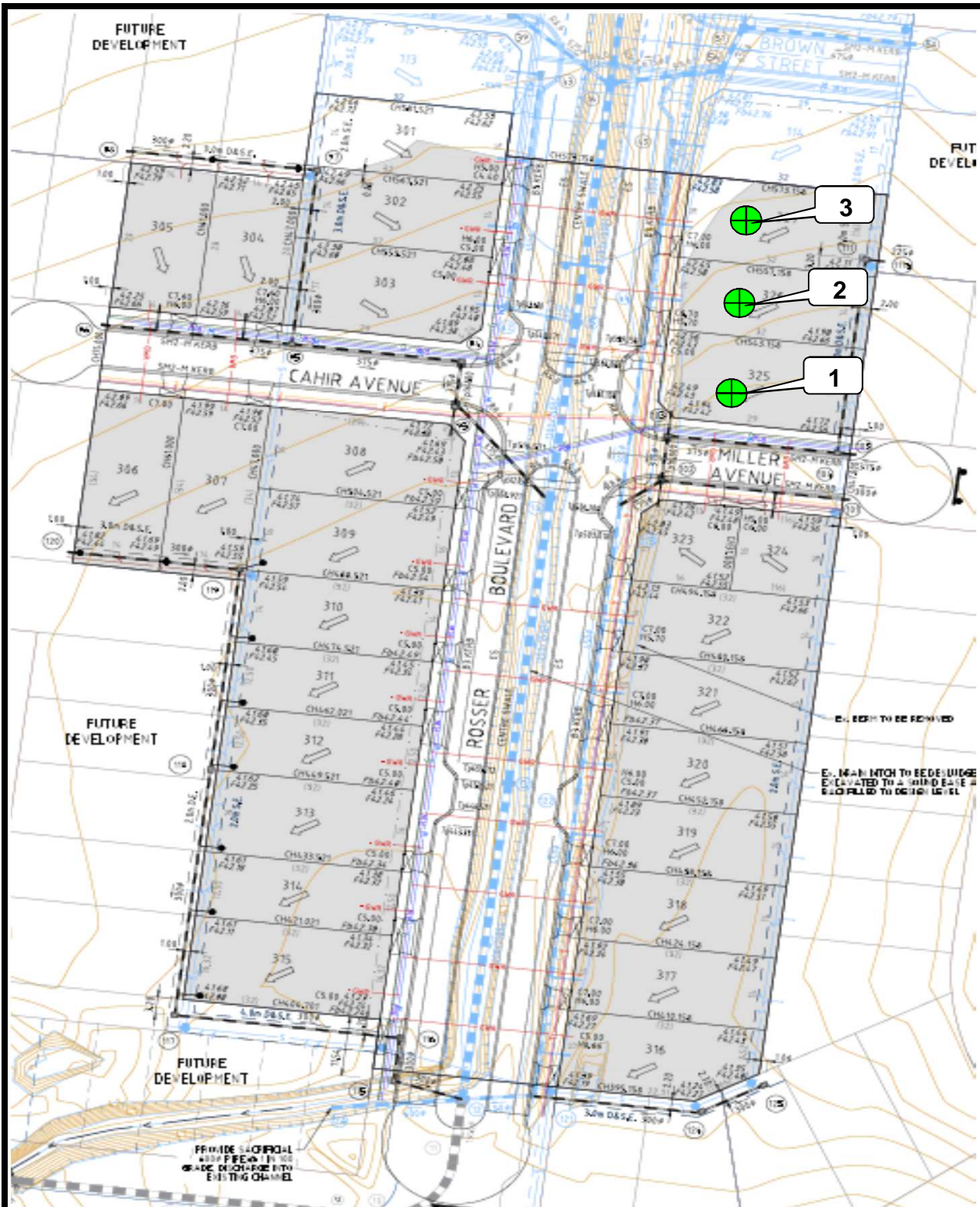

**GEOTECHNICAL LABORATORIES**

GEOTECHNICAL LABORATORIES  
 ACN 102 571 077  
 Factory 1/8-10 Catalina Drive, Tullamarine Vic 3043  
 PO Box 184 Keilor VIC 3036  
 PH: (03) 9335 1225 Fax: (03) 9335 1775

<b>CLIENT: DRAPERS</b>  <b>LOCATION: The Quay 2 Estate Stage 3</b>  <b>Sketch indicating approx. compaction test locations</b>	<b>DATE: 18/01/17</b>	<b>JOB No.: 1916/042</b>
	<b>OPERATOR: BE</b>	<b>CHECKED: CA</b>
	<b>SCALE: NTS</b>	<b>FIGURE No: -</b>