



GEOTECHNICAL LABORATORIES
 ACN 102 571 077
 Factory 1/8-10 Catalina Drive, Tullamarine Vic 3043
 PO Box 184 Keilor VIC 3036
 PH: (03) 9335 1225 Fax: (03) 9335 1775

DAILY SUMMARY - FIELD DENSITY TESTS

REPORT NO.: # 1916/008

LOCATION: DRAPERS - The Quay Estate Stage 3

DATE OF TESTS	TEST NUM.	TEST LOCATION	FIELD WET DENSITY (t/m ³)	FIELD MOISTURE CONTENT (%)	HILF DENSITY RATIO STANDARD (%)	STANDARD PCWD OR APCWD (t/m ³)	STANDARD OPTIMUM MOISTURE CONTENT (%)	PROBE DEPTH SETTING (mm)	VARIATION FROM OPTIMUM MOISTURE CONTENT (%)	MOISTURE RATIO (%)	WET +19mm (%)	WET +37.5mm (%)	APPROX. DEPTH BELOW FINISH LEVEL (mm)	
2/12/16	1	<i>Refer to #1916/009 for approx. test site locations.</i>	2.13	16.0	101.0	2.11	16.0	175	0.0 Drier	100.0	0	0	200	
2/12/16	2		2.01	16.0	96.5	2.07	15.5	175	0.0 Wetter	101.5	0	0	200	
2/12/16	3		2.07	19.0	103.5	2.01	19.0	175	0.0 Drier	100.0	0	0	200	
-	-		-	-	-	-	-	-	-	-	-	-	-	-
-	-		-	-	-	-	-	-	-	-	-	-	-	-
-	-		-	-	-	-	-	-	-	-	-	-	-	-

NOTES: Onsite Sandy Clay Fill

Test sites located - Geolab Procedure 4, Part 4.4.

Compaction specimens sampled after compaction.

Start Time: 1:07pm Finish Time: 1:22pm

A Hilf Rapid Compaction test was carried out on a sample taken from each Field Density location to obtain the Compaction Parameters tabulated on this Report.

Soil Layer thickness: 200mm

Hilf Density Ratio and Hilf Moisture Variation ,Hilf Adjusted (APCWD) & Peak (PCWD) Converted Wet Density AS 1289 5.7.1

Field Density, Nuclear Gauge: AS 1289 5.8.1

Materials Sampled : AS 1289 1.2.1 Clause 6.4(b)

❖

❖



Moisture Content: AS 1289 2.1.1

Compaction Test: AS 1289 5.7.1

Accredited for compliance with ISO/IEC 17025. The results of the tests, calibrations and/or measurements included in this document are traceable to Australian/National standards. This document may not be reproduced except in full.

NATA Accredited Laboratory Number 14561

SAM LOZA

(Approved Signatory)

Issue Date: 21/12/2016

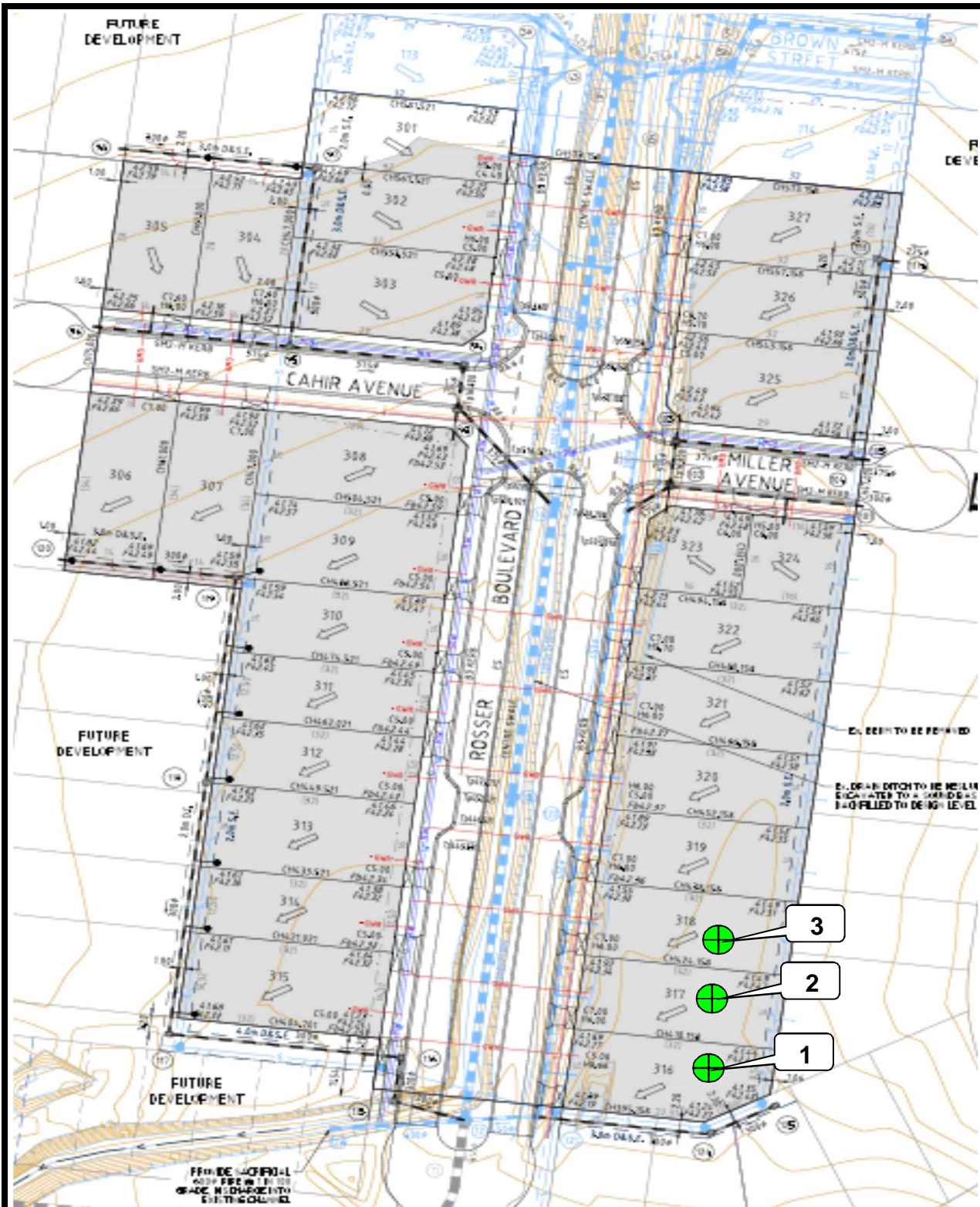

GEOTECHNICAL LABORATORIES

GEOTECHNICAL LABORATORIES
 ACN 102 571 077
 Factory 1/8-10 Catalina Drive, Tullamarine Vic 3043
 PO Box 184 Keilor VIC 3036
 PH: (03) 9335 1225 Fax: (03) 9335 1775

CLIENT: DRAPERS	DATE: 2/12/16	JOB No.: 1916/009
LOCATION: The Quay Estate Stage 3	OPERATOR: VR	CHECKED: JC
Sketch indicating approx. compaction test locations	SCALE: NTS	FIGURE No: -